

MINI DELUXE

WMD-150



This machine condenses Watanabe's technology into a compact unit, further enhancing your work efficiency.



High performance, ease of operation, and safety—all in one.

- Easy to disassemble, easy to clean.
- The exterior is anodized, and the material pressing device is made of stainless steel, making it resistant to rust and stains, ensuring it always remains sanitary.
- Features the same all-gear drive mechanism as the Super Deluxe model, providing smooth, high-performance operation.
- Thickness can be adjusted via a dial, and by switching the clutch, the unit can also be used manually.
- Good for slicing processed products such as ham, sausage, roast beef, and chashu pork.



■ DIMENSIONS PLEASE CHECK APPROVED DRAWING FOR FURTHER DETAILS.

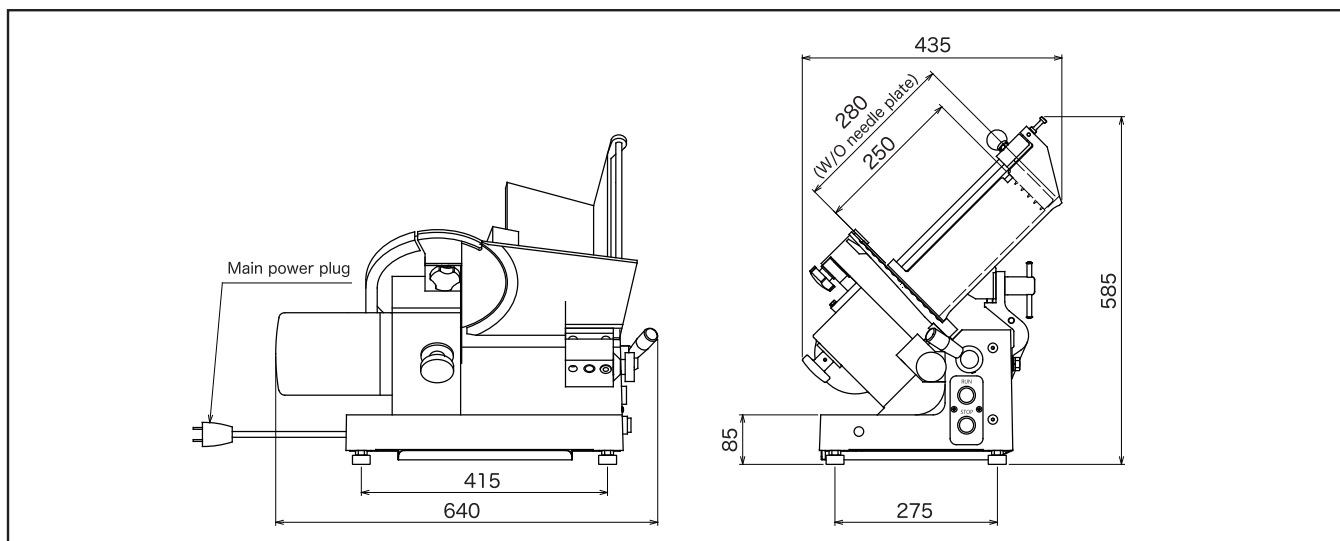

■ SPECIFICATIONS

MODEL	WMD-150
DIMENSIONS	W640*L435*H585mm
WEIGHT	38kg
PROCESSABLE DIMENSIONS	Circular: R150*L250mm Rectangular: W150*H130*L250mm
SLICE THICKNESS	0~20mm
CAPACITY	42slices/min(50Hz), 52slices/min(60Hz)
SLICE TEMPERATURE	-2°C~+5°C(Depends on product)
SLICE ANGLE	Fixed 0°
RATED ELECTRIC CAPACITY	OUTPUT 0.2kW, CURRENT 5.6A/4.8A(50Hz/60Hz)
POWER CONSUMPTION	170W/150W (50/60Hz w/o load)
POWER SUPPLY	1Phase 100V 50/60Hz More than 15A

⚠ SAFETY PRECAUTIONS

- Be aware of the blade
- The earth cable must be connected correctly
- Do not splash water into the machine
- Always install a protective guard in the operating range of the ham carriage.
- Do not slice bone-in meat
- Do not slice hard frozen meat
- Always be aware of the machine's moving and rotating parts.

WATANABE
WATANABE FOODMACH CO.,LTD.

2-12-26 TSUYUHASHI NAKAGAWA-KU NAGOYA JAPAN
TEL052-361-8511 FAX052-361-8490
URL : <https://www.foodmach.co.jp/>

SALES AGENT